



Berkshire & South Buckinghamshire ASA

County and Age Group Championships 2026

INFORMATION FOR COMPETITORS

ACCEPTED ENTRIES

All valid entries submitted meeting the consideration times have been accepted this year. All swimmers should check their entry information in the "Accepted Swims" document (please be careful if printing this document, it is over 600 pages!). Most errors in the entry information can be corrected before the meet (please email championships@bsbasa.org). It is unlikely that corrections will be possible on the day.

SESSION TIMES

The meet programme has been modified to accommodate all the accepted swims which required extending some sessions. This means some sessions will start up to 30min later than previously advertised and Session 11 will start 10min earlier.

The confirmed session times are as follows (changed times are highlighted):

Session	Date	Warm-up	Start	Paperwork submission deadlines
1	10 th January	08:30	09:15	Withdrawal forms by 08:30
2		13:15	14:20	Withdrawal forms by 13:15
3		17:00	17:45	Declare teams by 17:00
4	11 th January	08:30	09:05	Withdrawal forms by 08:30
5		12:15	13:20	Withdrawal forms by 12:15
6		16:55	17:40	Declare teams by 16:55
7	24 th January	08:30	09:05	Withdrawal forms by 08:30
8		12:15	13:20	Withdrawal forms by 12:15
9		16:30	17:15	Declare teams by 16:30
10	25 th January	08:30	09:05	Withdrawal forms by 08:30
11		11:50	12:55	Withdrawal forms by 11:50
12		16:25	17:10	Declare teams by 16:25

LEISURE CENTRE LAYOUT

Ground Floor

- Welcome Desk
- Changing Village
- Sports Hall
- Marshalling Area
- 50m Competition Pool
- 20m Community Pool

First Floor

- Spectator Gallery, Medal Table & Mailsports shop
- Official's Room

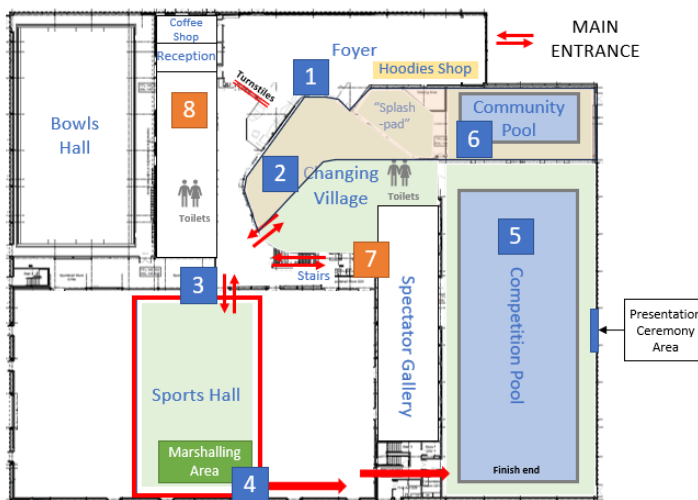

GETTING TO WYCOMBE LEISURE CENTRE

Wycombe Leisure Centre is located near junction 4 of the M40. From junction 4 follow the A404 "Marlow Hill" towards High Wycombe town centre and the leisure centre is signed on the right. Use postcode HP11 1UP for sat nav directions.

There are a number of car parks near the leisure centre:

Leisure Centre Car Park 60p for up to 2hrs, £1.10 up to 4hrs, £3.00 up to 10hrs. The machine accepts both cash and cards. This is a multi-storey car park next door to the leisure centre.

Park & Ride Card Park Free for 30mins, £1.40 up to 4hrs, £3.20 up to 10hrs, £4.20 per day. Payment is by card machine or "RingGo" app (location # 5251155). The card machine is often out of order so we recommend downloading the "RingGo" app before arriving if you have not used it before.

The park and ride car park is around 200m walk from the leisure centre and accessed by car via a dedicated entrance from the A404.

Waitrose Car Park There is a maximum stay of 2hrs and no return within 2hrs. Waitrose is next door to the leisure centre and has its own car park. Please observe their payment procedure that is likely to mean that you have to spend money at the store.

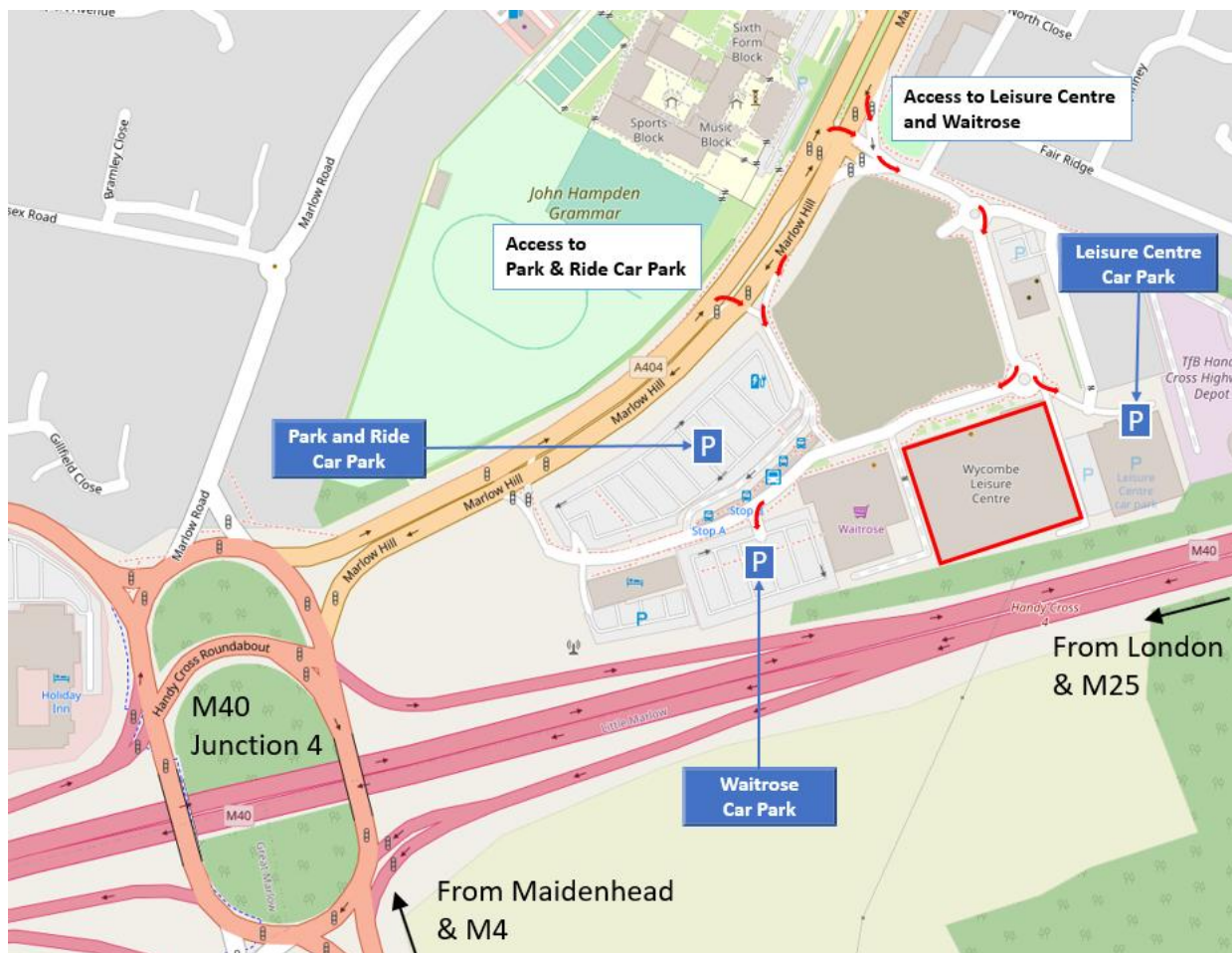

SHOPS & FOOD

Wycombe Leisure Centre has a small café in the foyer area offering sandwiches and hot drinks.

Waitrose supermarket is next door, which also has a café (note: this closes at 16:00 on Sundays).



Fine Designs will have a shop in the leisure centre entrance area, selling BSBASA County Championships branded sweat shirts and other clothing.



Mailsports will be upstairs selling performance swimwear and training equipment.

AWARDS & PRESENTATIONS

Age Group & Para-Swimming Medals

Medals for the Age Group 1st, 2nd and 3rd placed swimmers of each event can be collected from the medal desk at the entrance to the spectator gallery.

Para-Swimming multi-classification medals can also be collected from the medal desk for the 50m and 100m events.

County Medals and Trophies

Presentations of county medals and trophies for the junior and senior county awards take place poolside at the end of the session in which the event took place.

The 50m and 100m event awards take place after the finals in the last session each day. Trophies and a County Gold medal are awarded to the fastest junior swimmer (14yrs and under) and senior swimmer (15yrs and over) for each event. Junior and Senior County silver and bronze medals will be presented to the 2nd and 3rd placed swimmers.

For the team relay events, junior trophies will be presented to the winners of the “12-13yrs” age group, together with the gold, silver and bronze medals. The Senior trophy will be presented to the winners of the “Open” age group together with the gold, silver and bronze medals.

Medals will be presented to the 1st, 2nd and 3rd placed teams for the “10-11yrs 4x50m”, “16 & Under 4x100m”, “4x50m Mixed” and “Squadron” Relay events.

Details of the trophy presentations are available in the meet programme.

THE SPECTATOR GALLERY

Spectator entry is charged at £6 for 1 session or £10 for the whole day. Credit/Debit card payments only please, **cash will not be accepted**. Entry is free for children under 12 and pensioners).

Programmes will be available to download from the BSBASA website. <https://bsbasa.org/>.

Wrist bands will be provided as proof of payment. Anyone without a wristband will be refused access to the gallery.

The spectator gallery has priority areas for wheelchair access. The walkways and stairways must be kept clear to maintain escape routes in case of an emergency.

We ask spectators not to ‘set up camp’ on seats and then leave them unused for part of the day. At busy times we reserve the right to make empty ‘reserved’ seats available in order to allow other spectators to sit.

Access at the far end of the spectator gallery opposite the pool finishing end is restricted to authorised personnel only.

COMPETITOR ONLY AREAS

Access to the changing village, swimming pool and sports hall will be restricted during the meet. Our volunteers will patrol these areas to control access. Only swimmers and those with poolside passes will be allowed in these areas. Parents should not enter these areas

POOLSIDE & SPORTS HALL

Each club will be allocated an area of the sports hall for their swimmers to use during the meet for relaxing and land warm up. The marshalling area is also in the sports hall.

Swimmers should only use the corridor between the pool and the sports hall to walk out for their event when directed by the stewards. Access to the sports hall is from the foyer, not directly from poolside. The staircase between the spectator gallery and corridor is only to be used by the meet officials and promoter's team.

Swimmers may only bring small bags poolside. Large bags must be left in the lockers in the changing village or in the sports hall (with the permission for your TM/Coach). The BSBASA takes no responsibility for bags left in the sports hall.

If the poolside area becomes overcrowded, we will ask coaches and TMs to send some of their swimmers to the sports hall.

THE CHANGING VILLAGE

The leisure centre has a mixed gender changing village. The changing area will be patrolled during the meet by our volunteers. Additionally a security guard will be located in the foyer at the entrance to the changing village.

Swimming lessons will be taking place in the community pool on Saturday until 15:00. Learners and their carers/families will be directed to use the section of the changing area adjacent to the splash area and community pool. Similarly, until 12:30 on Sundays public swimming will take place in the Community pool and they will also be using the same area of the changing rooms. Swimmers are requested to use the main section of the changing village and not the area reserved for the public during these times.

Safeguarding rules mean that under no circumstances should mobile phones or cameras be used in the changing village. **Anyone seen using a phone or camera in the changing area risks being immediately removed from the event.**

Do not leave bags in the changing cubicles or anywhere in the changing village, except in the lockers provided. **You will need a padlock to secure your locker.**

Swimmers leaving the changing area to visit other parts of the leisure centre must be dry, wearing appropriate clothing and footwear. **Swimmers must not use the dry side changing rooms.**

REPORTING FOR EVENTS

It is the responsibility of each swimmer to arrive at the marshalling area in the sports hall and report to the competitor stewards in good time for their event. Swimmers should check the starts list which heat and lane number they are in for each event.

Hard copies of the start lists will be provided to coaches and TMs, and posted up on the walls in the sports hall and spectator gallery. Additionally, the start lists can be accessed online and will be available before the start of each session. Please check with your coach or Team Manager if you are unsure before arriving at the marshalling area. Please note that all events are seeded slow to fast.

It is very important that competitors follow the instructions of the stewards. For swimmers who are poolside, the marshalling area should be accessed via the changing rooms and the foyer. Do not try to access the sports hall directly from poolside as you will be turned back.

WITHDRAWING FROM AN EVENT

It is very important that swimmers withdraw from any event they have entered but do not intend to swim. If swimmers do not withdraw, heats will inevitably be swum with empty lanes.

Swimmers should notify any withdrawals to their team manager as soon as they can, who will then inform the meet organisers before the warm-up of the session. The number of empty lanes will be monitored by the meet organisers. Clubs with an unacceptable level of unreported withdrawals will be reported to the Performance Swimming Events Committee who may impose a penalty, including a fine.

WITHDRAWING FROM FINALS

The list of finalists for the 50m and 100m events will be published as soon as possible after the heats have been completed. The list of finalists will be announced with a "withdraw by" time. Finalists and reserves who need to withdraw (which should only be in exceptional circumstances) must notify their club's team manager, who will in turn notify the meet organisers before the published "withdraw by" time for the relevant final.

A fine of £10 may be levied on clubs in respect of each no show in finals (including promoted reserves). The entry process for future BSBASA performance swimming competitions will be blocked for clubs with unpaid fines.

THE COMMUNITY POOL

The 20m Community Pool will be available after 15:00 on Saturdays and 12:30 on Sundays for swimmers to use for warm-up and for swim down after their events. The depth of this pool is a constant 1.2 meters. There is to be no diving into the community pool at any time. During the warm-up, para-swimmers will be given priority use of the community pool.

BACKSTROKE LEDGES

We will be providing backstroke ledges. You do not have to use them if you do not wish to.